

# DBX1000

## DRYER VENT BOX



### AVAILABLE SIZES:

- 4" (FOR 2X4 FRAMING)
- 6" (FOR 2X6 FRAMING)

### MATERIAL:

- MADE OF HIGH IMPACT POLYSTYRENE (PLASTIC)
- MEETS IRC REQUIREMENTS
- RUST PROOF
- WHITE FINISH – MATCHES THE WASHER BOX

### APPLICATION:

- NEW CONSTRUCTION OR RETRO FIT
- UP/DOWN/OR DIRECT VENTING
- KNOCKOUTS PROVIDED (14" SQUARE)



• PATENTED PRODUCT

DBX1000 IS DESIGNED SPECIFICALLY FOR DETACHED SINGLE FAMILY HOMES

# DBX1000M

## DRYER VENT BOX



### AVAILABLE SIZES:

- 4" (FOR 2X4 FRAMING)
- 6" (FOR 2X6 FRAMING)

### MATERIAL:

- MADE OF 22 GAUGE STEEL
- MEETS IMC & IRC REQUIREMENTS
- POWDER COATED TO MATCH THE WASHER BOX—ELIMINATES THE NEED TO PAINT

### APPLICATION:

- NEW CONSTRUCTION OR RETRO FIT
- UP OR DOWN VENTING



• PATENTED PRODUCT

DBX1000M IS DESIGNED FOR BOTH SINGLE AND MULTI-FAMILY APPLICATIONS

# IT'S ALL ABOUT THE TRIM RING!

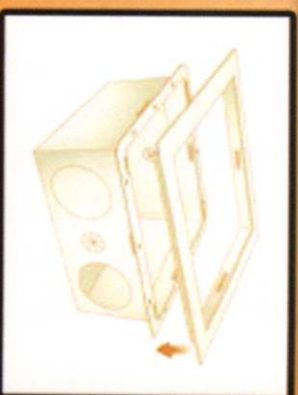

### FEATURES:

- ELIMINATES COSTLY BACK END DRYWALL AND PAINT REPAIRS
- ELIMINATES THE NEED FOR CAULKING
- MATCHES THE WASHER BOX



*PROVIDES* A CLEAN FINISHED LOOK TO YOUR LAUNDRY ROOM

• PATENTED PRODUCT

THE TRIM RINGS FOR BOTH THE DBX1000 & DBX1000M ARE PACKAGED SEPARATELY SO THEY ARE NOT LOST ON THE JOB SITE

# WHY DO YOU NEED A DRYER VENT BOX?



## DBX DRYER VENT BOXES ACCOMPLISH THE FOLLOWING:

- ✓ ELIMINATES THE KINKED HOSE BEHIND THE DRYER
- ✓ ELIMINATES THE 90 DEGREE ELBOW THEREFORE GAIN 5' OF RUN
- ✓ REDUCES LINT BUILD UP THAT CAN RESULT IN FIRE AND PROPERTY DAMAGE
- ✓ ALLOWS FOR THE DRYER VENT HOSE TO BE PROPERLY RECESSED AND INCREASE AIRFLOW
- ✓ HELPS WITH DRYER EFFICIENCY
- ✓ ALLOWS FOR THE DRYER TO BE MOVED CLOSER TO THE WALL (MORE USABLE FLOOR SPACE)

**Construction**  
SOLUTIONS



# DBX DRYER VENT BOXES



DBX1000  
(PLASTIC)



DBX1000M  
(METAL)



Construction Solutions  
7918 E. McClain Dr. Suite 1  
Scottsdale, AZ 85260  
[www.dryersolutions.com](http://www.dryersolutions.com)

Toll Free: 866.270.8240  
Fax: 480.346.8250  
[www.dryersolutions.com](http://www.dryersolutions.com)